

## Pump and Filter Assembly Guide

Waterways 2 SpeedHP / 100SQF



### STEP 1

---

Remove the base and locate the four pre-drilled holes where the pump mounts.



### STEP 2

---

Unscrew the four bolts to secure the pump in place.



### STEP 3

---

Locate the threaded hose adapters and the teflon tape. It is okay to use a wrench to tighten, just take care not to break the fitting.

**Helpful Tip:** Use Vaseline or Teflon tape around the threads to prevent drip leaks.



## STEP 4

---

Locate the four holes for the filter assembly. Secure the filter assembly to the base.



## STEP 5

---

With filter and pump in place, use the shorter 3' flex hose to connect from the "In" of the filter housing to the top of the pump. Use the hose clamps to tighten.

TIP: The hoses are plastic and may be stubborn to get all the way down on to the fitting. Dip them in boil hot water for a few seconds and they will slide all the way down.



As the pictures show, the hoses may only want to be just on the tips of the hose adapter. This is not secure.



**WRONG**



**RIGHT**

Be sure to push the hoses all the way down on to the fitting before attaching the hose clamp.

## STEP 6

---



Locate the “Bleeder Valve” on the top of the filter. When you first start up your pump and filter, air will need to be released out. Unscrew this slightly. As the pool fills, water will eventually shoot out from here. Tighten and run your pump fully.

## STEP 7

---



On the filter top is also a pre-drilled opening. Here you will need to screw in the pressure gauge. This gauge will help you know when to clean your filter element.

## STEP 8

---



Attach the hoses and secure with the hose clamps. **Make Sure the Hose going from the White Filter Housing marked “OUT” is Attached to the Gate Valve with the Eyeball Diverter.** Refer to the Plumbing Kit Assembly Guide for a diagram of the eyeball diverter.

### **When to Clean the Filter:**

The gauge face shows back pressure based on how dirty or clean your cartridge is. Note that then gauge is (usually) marked in 10s.

Every pump and filter will have a different starting point. When you get your pump and filter up and running, after about 10 minutes of operation, mark where the needle is and that is your indication of a new/clean cartridge.

**When the gauge reads 10-15 more than when it started, it is time to clean the element.**



**On/Off Switch in the back of the pump motor.**



## How to Clean the Filter:

Lift up the grey locking tab, unscrew the black locking ring (counter-clockwise), and remove the filter housing lid. Note: it is vacuum-sealed, so it will resist remove. you can use a dull kitchen knife to help "pry" it open. Take care not to damage lid or housing.



**Warning: Never Open Lid While Pump is Running or With Gate Valves Opened**



## REPLACEMENT PARTS

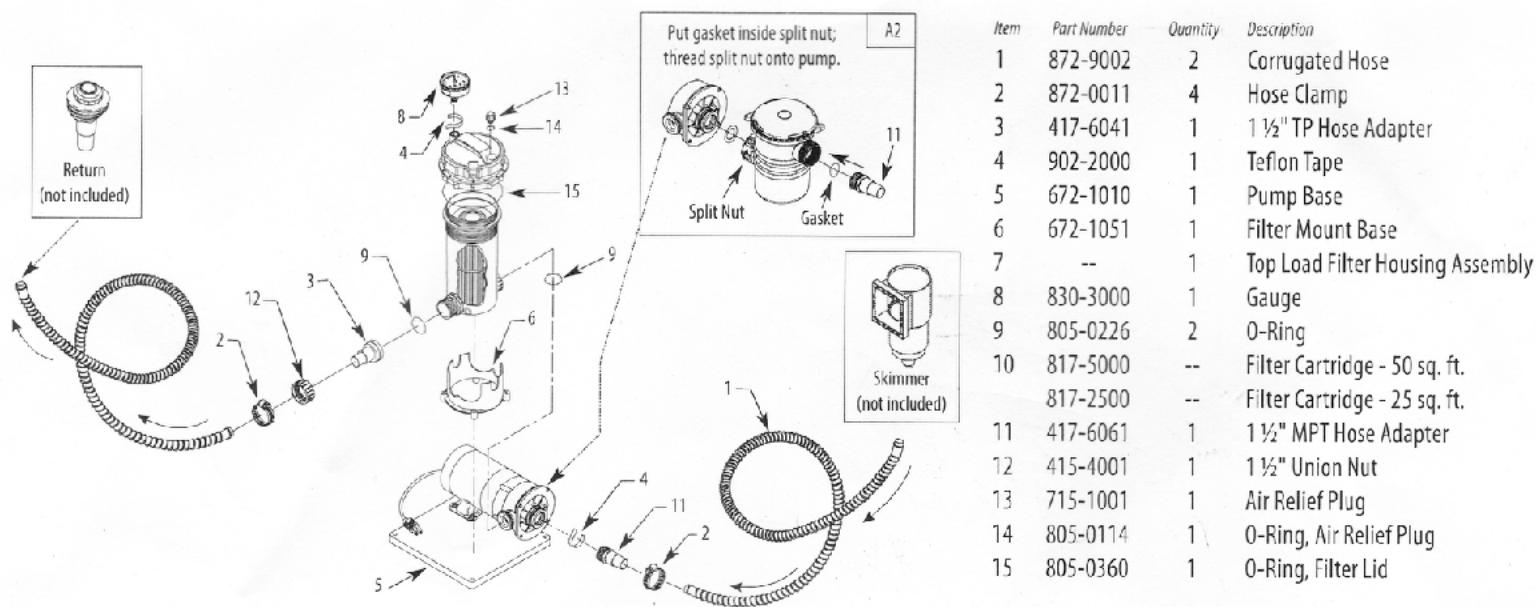

Be Sure it's  
Genuine



**EZ Pool Products, Inc.**  
**Portable Swimming Pools**  
Easy and Affordable Pool Packages